

UPSIDE DOWN

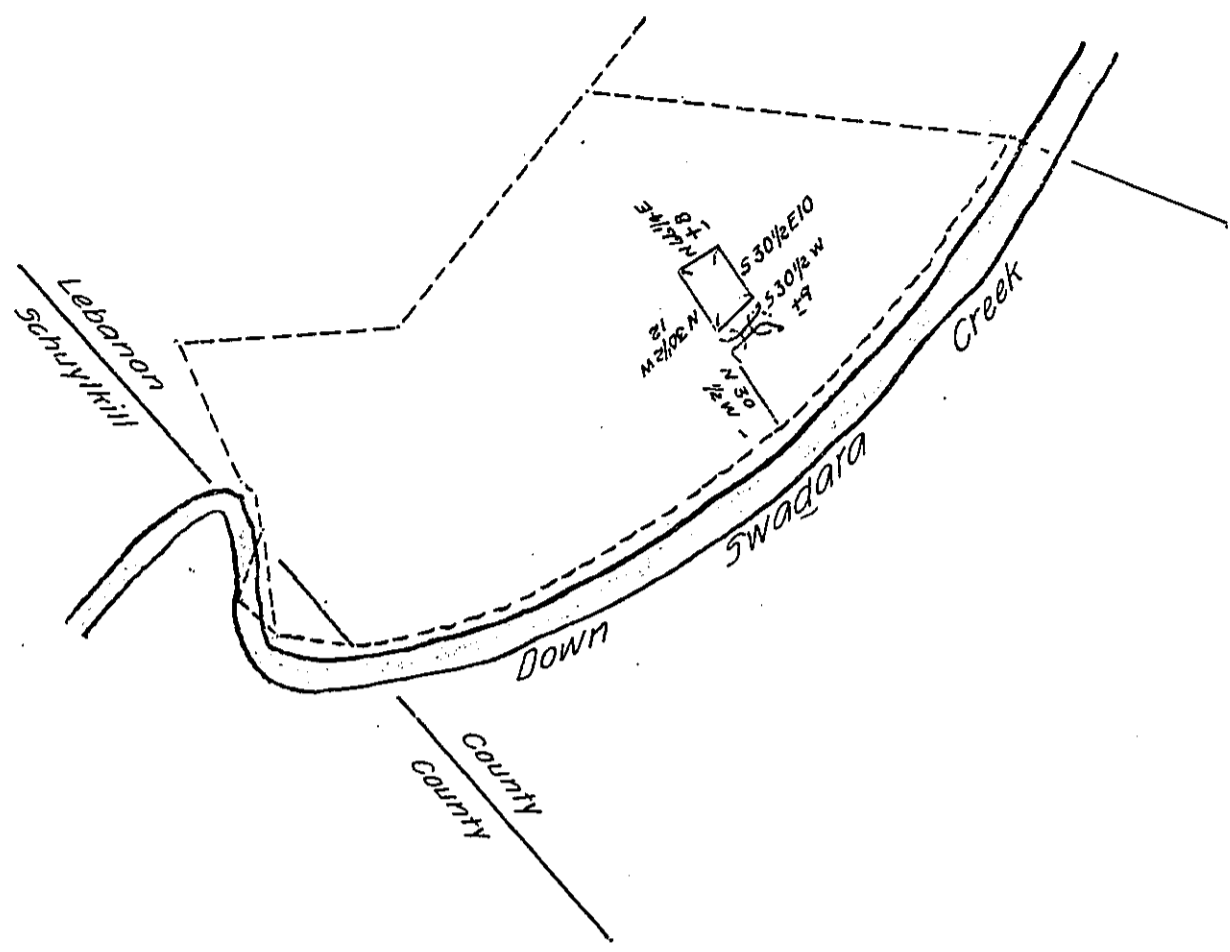

The above described tract of land situate in Bethel Township  
 Lebanon County Pa containing seventy nine perches and the allowance  
 of six per cent it being part of 31 acres and 130 perches surveyed to  
 William Poor on application N<sup>o</sup> 555 situate in the aforesaid Bethel Town-  
 ship and the above seventy nine perches whare surveyed July 5<sup>th</sup> 1873  
 To Elizabeth Moos  
 To Robert B Beath  
 Surveyer General of Pa.

Martin Meily D SUR  
 for Lebanon Co.

IN TESTIMONY that the above is a copy of the original remaining on file in  
 the Department of Internal Affairs of Pennsylvania, made  
 conformably to an Act of Assembly approved the 16th day of  
 February, 1833, I have hereunto set my Hand and caused  
 the Seal of said Department to be affixed at Harrisburg,  
 this eighteenth day of April 1906

*Loach R Brown*  
 Secretary of Internal Affairs.